

Before fitting bath please ensure:

1. Sub-floor is strong enough without flexing to carry the weight of Bath + water + person.
2. Unsure the sub floor is flat and even without high spots and dips.
3. When tilting bath ensure it is supported on a soft material to avoid edge chipping.

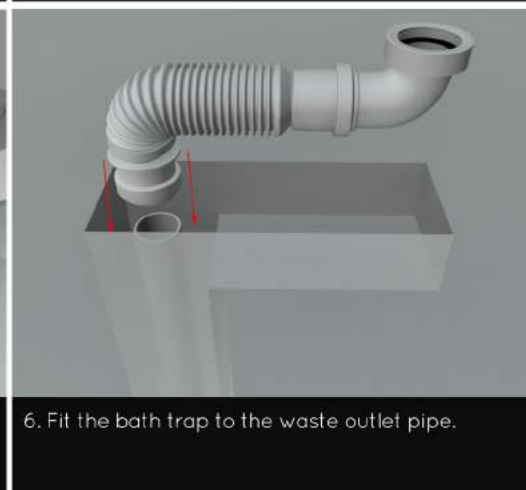
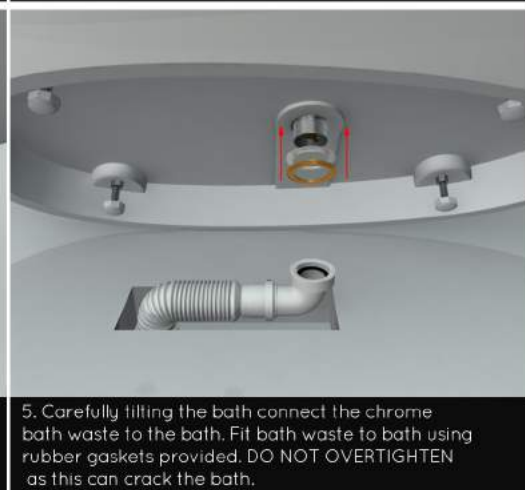
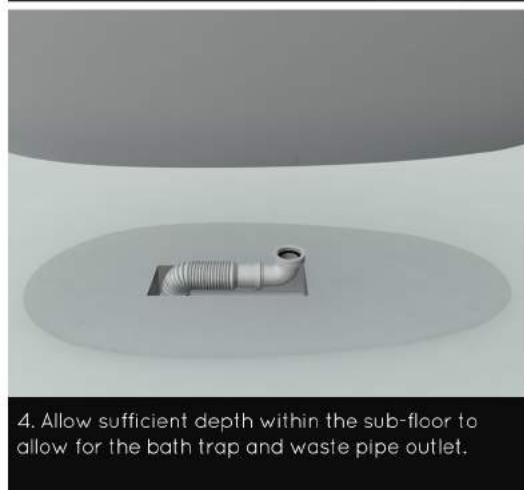
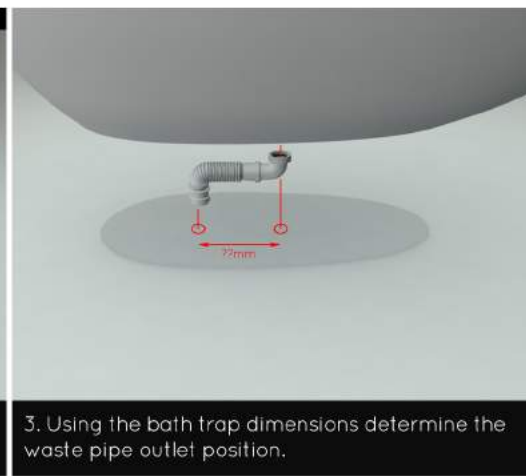
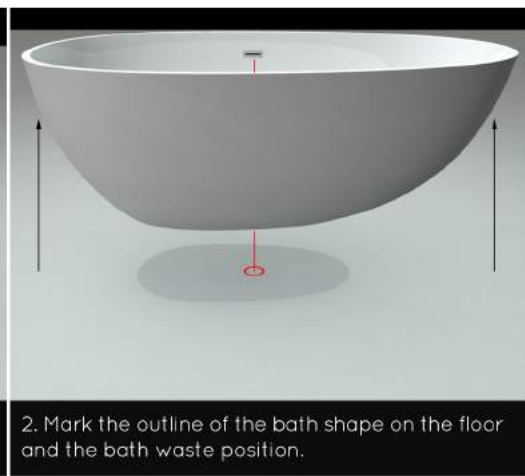

1. Carefully place the bath into position ensuring the floor is clean, flat and level.

2. Mark the outline of the bath shape on the floor and the bath waste position.

3. Using the bath trap dimensions determine the waste pipe outlet position.

4. Allow sufficient depth within the sub-floor to allow for the bath trap and waste pipe outlet.

5. Carefully tilting the bath connect the chrome bath waste to the bath. Fit bath waste to bath using rubber gaskets provided. **DO NOT OVERTIGHTEN** as this can crack the bath.

6. Fit the bath trap to the waste outlet pipe.

7. Fit the bath trap to the bath waste

8. Adjust feet so the bath skirt is at least 1mm clear of the floor. (For baths without adjustable feet, pack the skirt rim to be at least 1mm clear of the floor) Silicon bead entire bath to floor perimeter.

9. Check the bath levels again and leave the silicone to cure for 24 hours.

For help and advice on Livinghouse stone resin baths please contact us by phone, email or visit our website.

Tel: 01722 415000

Email: sales@livinghouse.co.uk

Website: www.livinghouse.co.uk

Livinghouse stone resin baths are available to view from our Salisbury showroom please contact us for more details.

Showroom address

livinghouse, Unit 3 Ashfield Trading Estate, Ashfield Road, Salisbury, SP2 7HL